

Akuvox

IT82 Indoor Monitor User Manual

Content

1 Production Overview	4
1.1 Production Description	4
1.2 Technical Specification	4
1.3 Button Instruction	5
1.4 Dimension	5
1.5 Equipment Appearance And Interface Description	7
1.6 Installation.....	8
1.7 Installation Considerations	9
1.8 Equipment Packaging.....	9
2 Setting.....	10
2.1 Main interface instruction	10
2.2 Network.....	11
2.2.1 DHCP	11
2.2.2 Static IP.....	11
2.3 Register Account	12
2.4 Display.....	14
2.4.1 Brightness.....	14
2.4.2 Sleep.....	14
2.5 Sound	14
2.5.1 Sound	14
2.5.2 Call Ringtone Vibrate	15
2.5.3 System.....	15
2.6 Time	15
2.7 DND Setting.....	16
2.8 Language	17
2.9 System	18
2.10 Backup.....	18
3 Function.....	20
3.1 Make a call	20
3.1.1 Call SIP.....	20
3.1.2 Call resident	21
3.1.3 Call from Call Log	21
3.1.4 Call from Contacts.....	22
3.1.5 Call DoorPhone	23
3.1.6 Call Center.....	23
3.2 Receive a call	24
3.3 Answer a call	24
3.4 Reject a call	26

3.5	Contacts	26
3.5.1	New contacts.....	26
3.5.2	Modify the contact.....	26
3.5.3	Delete the contact.....	27
3.6	Call log.....	27
3.6.1	Modify the call log	28
3.6.2	Delete the log.....	29
3.7	Capture.....	29
3.8	DND	29
3.9	Auto Answer.....	29
3.10	Message	30
3.10.1	Alarm.....	30
3.10.2	Message	30
3.10.3	Maintenance	30
3.11	Live View	31
3.12	Unlock	31
3.13	SOS	31
3.14	Security	32
3.15	System Advanced	33
3.15.1	SSH console	33
3.15.2	Upgrade.....	34
3.16	Upgrade.....	34

1 Production Overview

1.1 Production Description







IT82 is an Android SIP-based with smooth touch-screen Indoor monitor. It can be connected with Akuvox door phone for unlock and monitor. Residents can communicate with visitors via audio and video call, and support remote unlock the door. It is more convenient and safe for residents to check the visitor identity through its video preview function. IT82 is often applicable in villas , apartments, building and so on

1.2 Technical Specification

Model	IT82
Graphic Display	● 7 inch capacitive touch screen TFT LCD, 1024x600 resolution, 16:9 wide screen aspect ratio
Network Protocol	● SIP RFC3261,TCP/UDP/IP,RTP
Voice Codec	● G.711A/U, G.729, G.722, iLBC_13_3, iLBC_15_2,OPUS
Video Codec	● H.264, H.263,H.265,MJPEG
Network Interface	● Dual switched 10/100Mbps port
IP assignment	● Static IP, DHCP

Memory	<ul style="list-style-type: none"> ● RAM:2GB, Flash:4GB
Management	<ul style="list-style-type: none"> ● LCD Menu Configuration, WebUI
Dimension	<ul style="list-style-type: none"> ● 232x160x21mm
Storage	<ul style="list-style-type: none"> ● Album ● External SD device

1.3 Button Instruction

Interface	Description
	Manage center button. Click to make a call with manage center.
	Message button. Click to direct access to message interface.
	Monitor button. Click to view the monitoring from outdoor environment.
	Intercom button. Click to enter the dialing interface.
	Unlock sensor button. The physical Unlock key is only used for E10S now.

1.4 Dimension

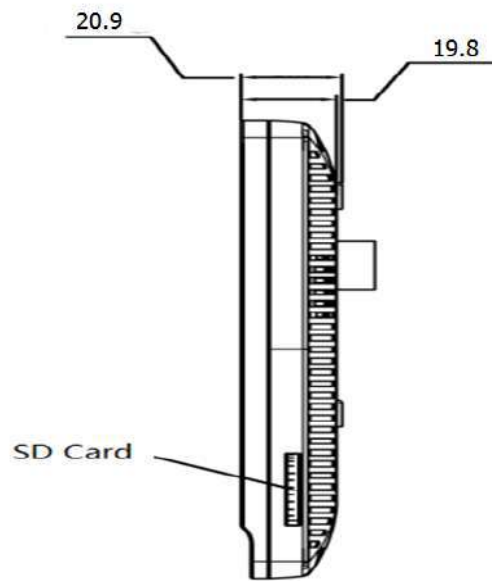
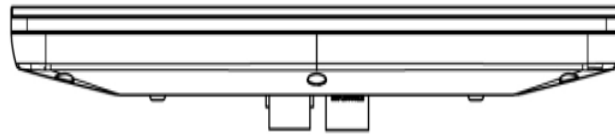
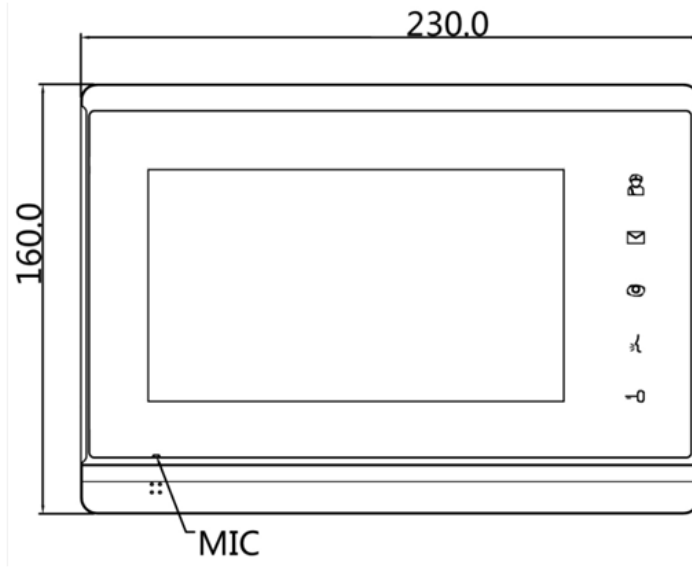

1.5 Equipment Appearance And Interface Description

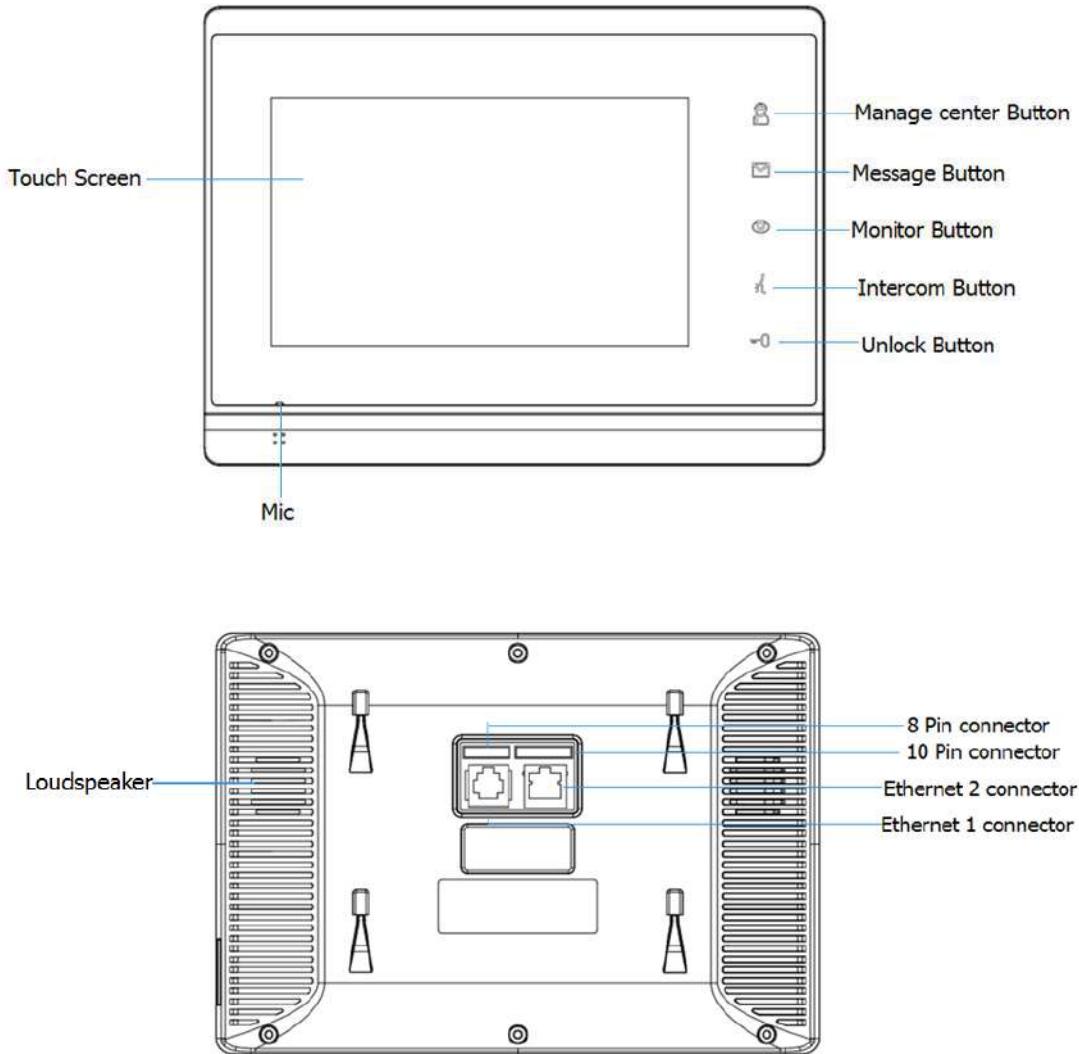

Interface	Description										
8 PIN connector	<table border="1"> <tr> <td>+12V</td> <td>GND</td> <td>X</td> <td>X</td> <td>485+</td> <td>485-</td> <td>NO</td> <td>COM</td> </tr> </table> <p>For power supply and 485 connector</p>	+12V	GND	X	X	485+	485-	NO	COM		
+12V	GND	X	X	485+	485-	NO	COM				
10PINconnect	<table border="1"> <tr> <td>IO1</td> <td>IO2</td> <td>IO3</td> <td>IO4</td> <td>IO5</td> <td>IO6</td> <td>IO7</td> <td>IO8</td> <td>X</td> <td>GND</td> </tr> </table> <p>For 8 security connector</p>	IO1	IO2	IO3	IO4	IO5	IO6	IO7	IO8	X	GND
IO1	IO2	IO3	IO4	IO5	IO6	IO7	IO8	X	GND		
Ethernet 1	Network interface can be connected to a hub, switch or other network access devices.										
Ethernet 2	Share the network access from ethernet 1 port, and for PC and other equipment connection.										

1.6 Installation

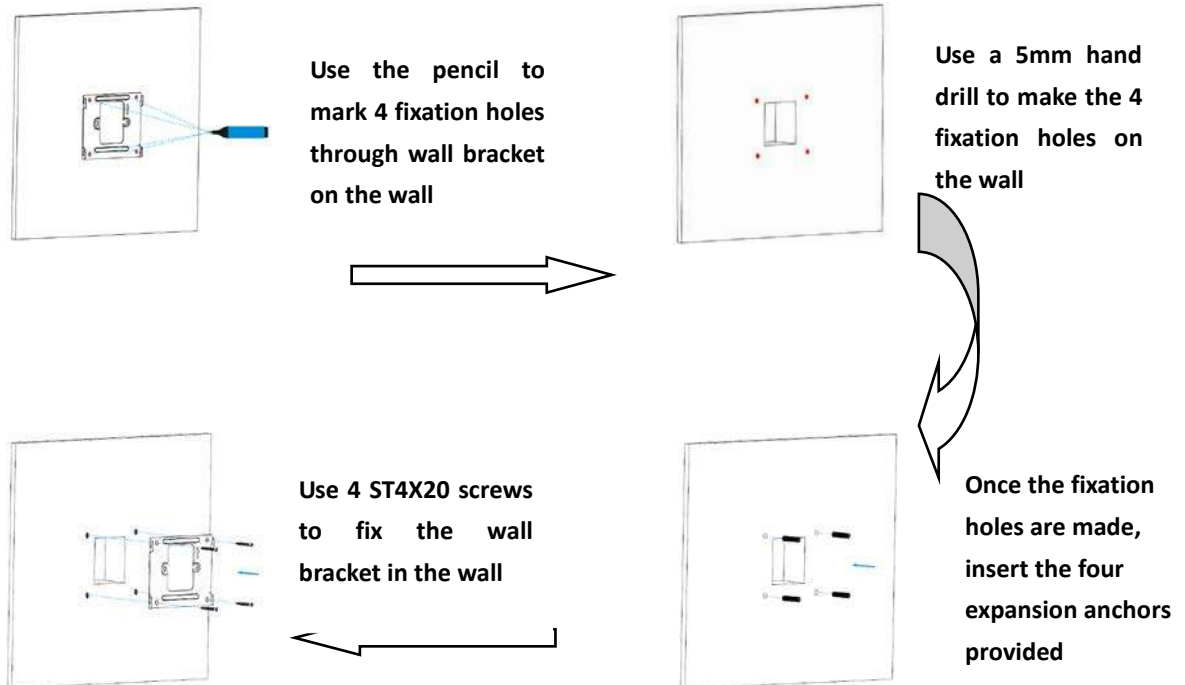

Device Mounting

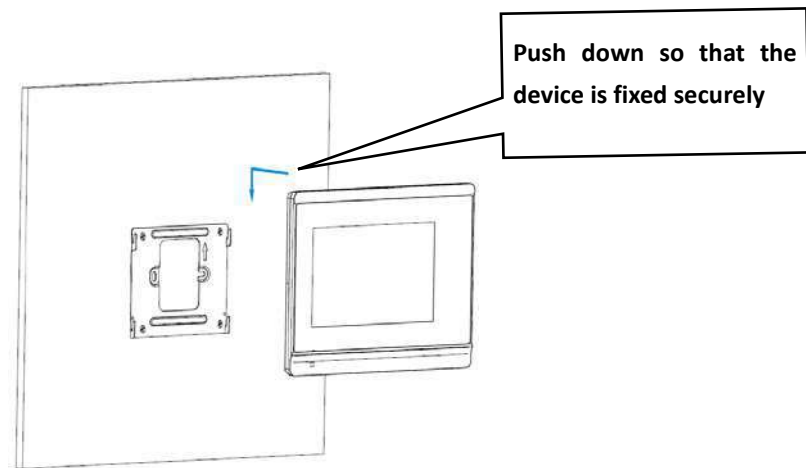

1.7 Installation Considerations

Here are some safety recommendations about the installation and the usage:

- Do not use this product near water, such as: bath, washbasin, kitchen sink and other damp places and so on.
- Place the device in a place away from heat.
- Place the device away from traffic areas to prevent collisions.
- Please use the equipment with the matching power adapter or POE.

1.8 Equipment Packaging

Name	Quantity
IT82	1
Wall bracket	1
Quick Start Guide	1
10 Pin cable	1
8 Pin cable	1
Expansion anchor	4
ST4x20 screw	4

2 Setting

2.1 Main interface instruction

It82 supports two pages of main interface. Click the corresponding area to operate.

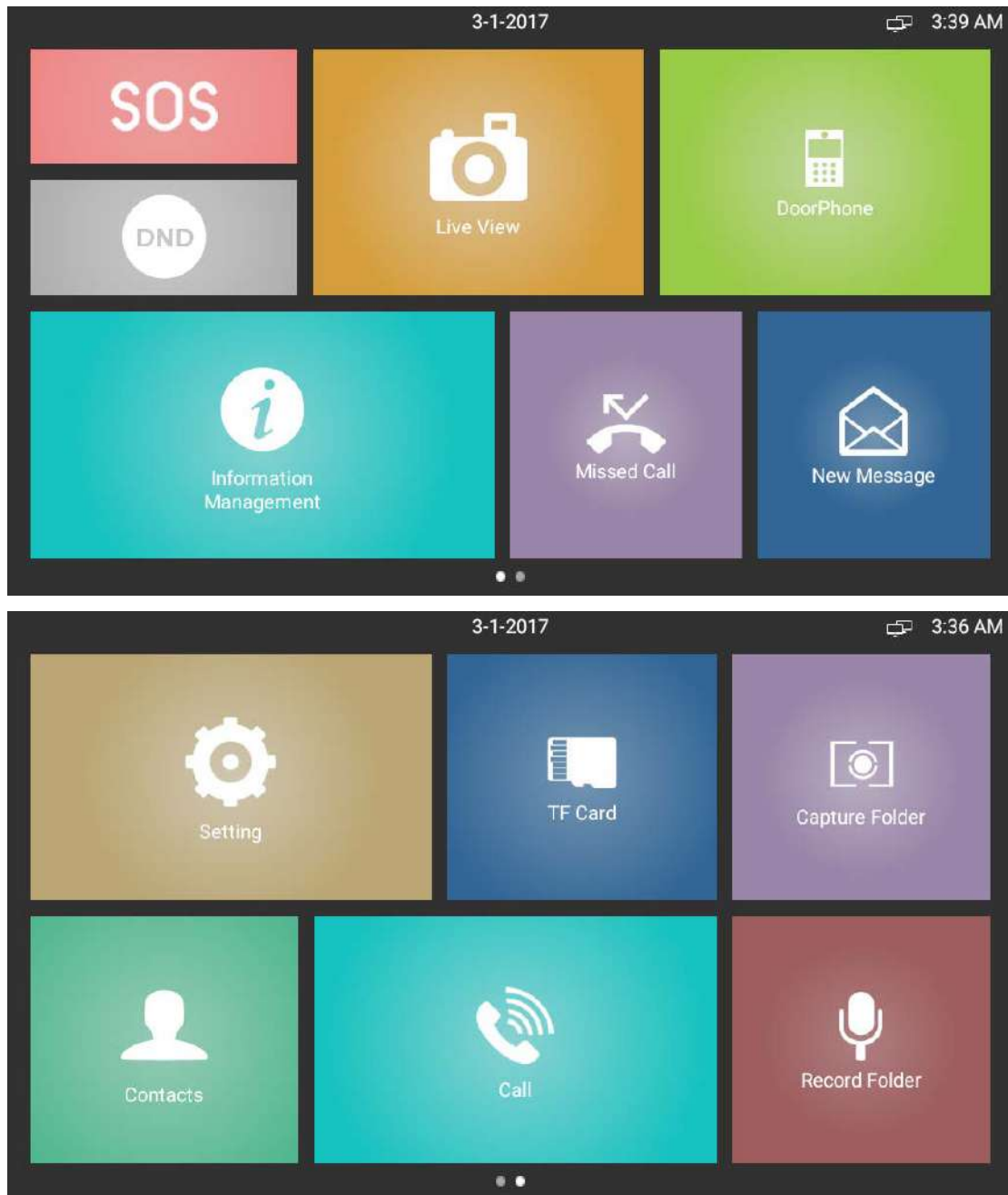

2.2 Network

2.2.1 DHCP

IT82 use DHCP mode to get IP address by default. Please go to Setting-Advanced(password:123456)-Network

Choose DHCP,press CONFIRM, the phone will get IP address automatically.

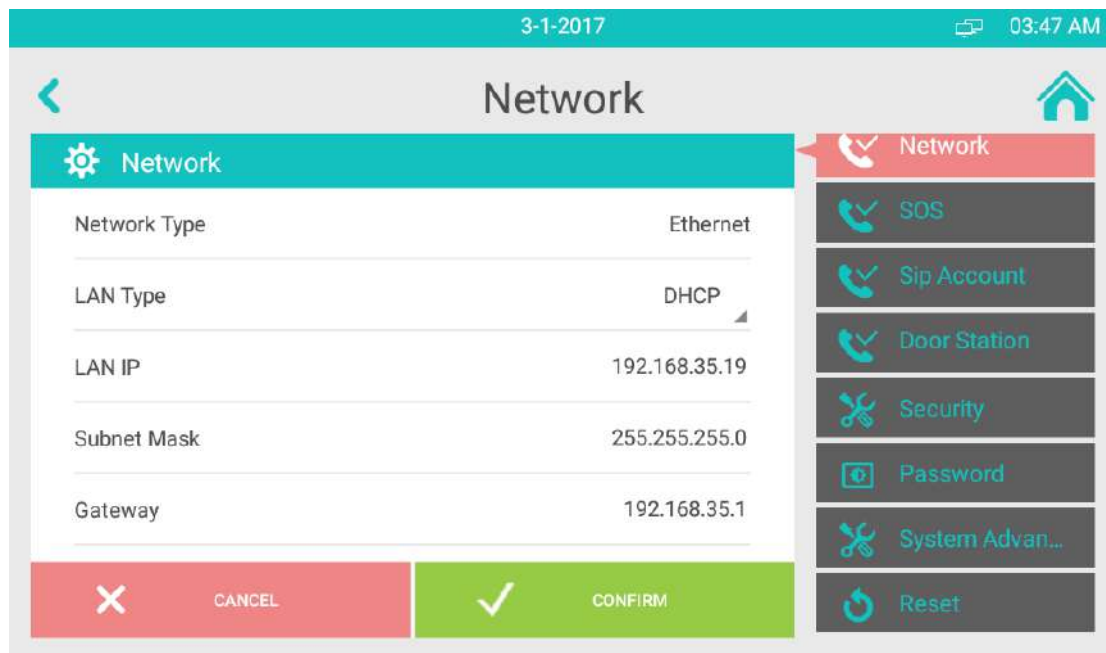

2.2.2 Static IP

Select Static IP in LAN Type. Enter the IP address parameters in the corresponding area.

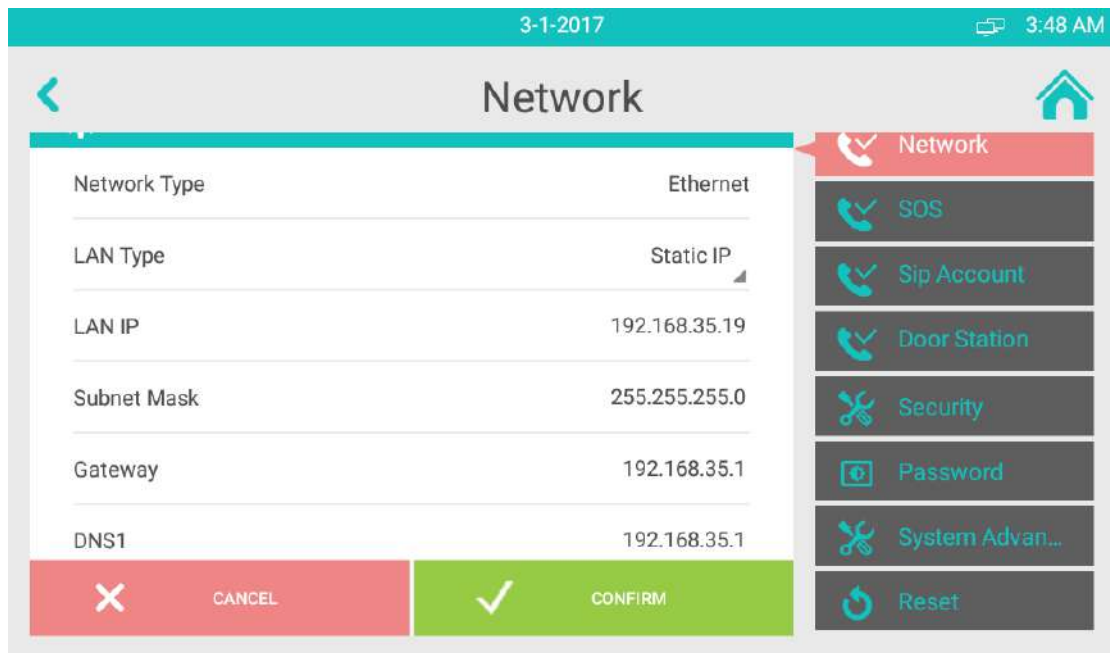

Parameter	Specification
IP address	set the IP address of the device
Subnet Mask	set the subnet mask of the device
Gateway	set the default gateway
DNS 1	set the DNS address
DNS 2	set the backup DNS address

2.3 Register Account

SIP account is provided by SIP server. Go to Setting-Advanced-Sip Account . Please consult administrator about sip server information.

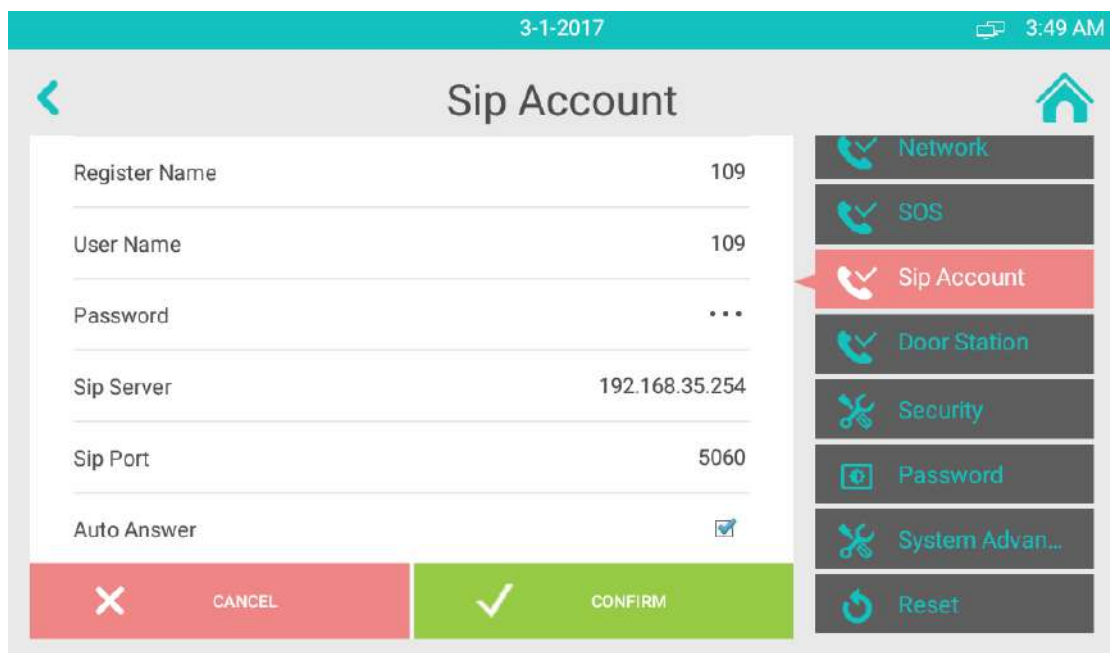
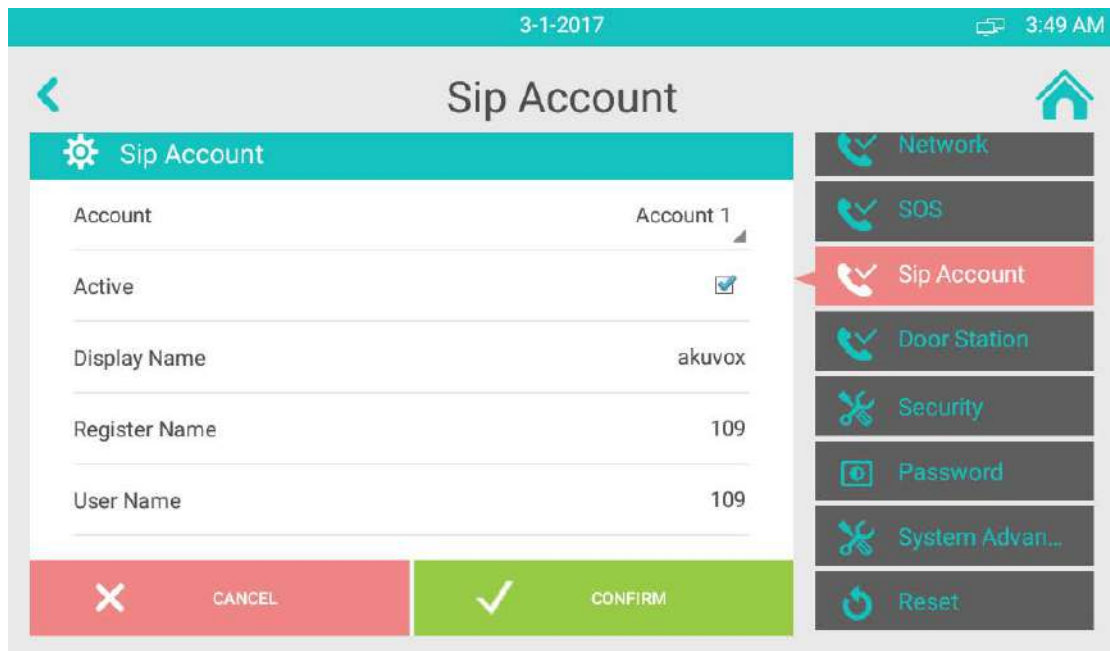

Fill the parameters in the corresponding area. Click CONFIRM to save.

Parameter	Specification
Register Name	SIP Account ID provided by ISP
User Name	SIP User Name provided by ISP
Password	SIP Password provided by ISP
Display Name	SIP Display name
Reg Server IP	SIP Register Server, format: domain/IP, for example: 194.168.1.2
Reg Server Port	The default port is 5060.

2.4 Display

2.4.1 Brightness

Slide the point left or right to adjust the screen brightness, click CONFIRM to save.

2.4.2 Sleep

Choose the sleep time from 15 seconds to Never. IT82 setup 1minute by default.

After the sleep time without any operation, the phone will black screen. Touch it to wake up.



2.5 Sound

2.5.1 Sound

Slide the point right or left to adjust the Ring / Talk/Tone Volume.



2.5.2 Call Ringtone Vibrate

To setup the Phone Ringtone and Default Notification Sound from the list.

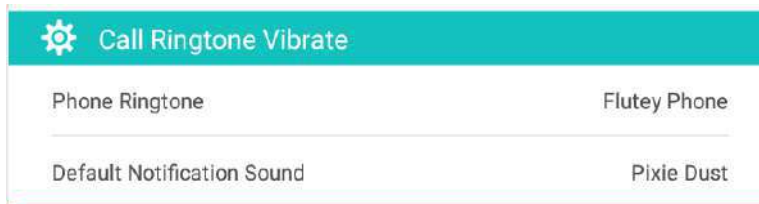

2.5.3 System

Enable or disable the Touch Sounds.



2.6 Time

Setup the date and time in the corresponding area.

Enable Automatic Date Time , the phone will get the Date and Time automatically.

If you uncheck Automatic Date Time, users need to setup the Date and Time manually.

Users can also select the suitable Time Zone and use 24-Hour format.

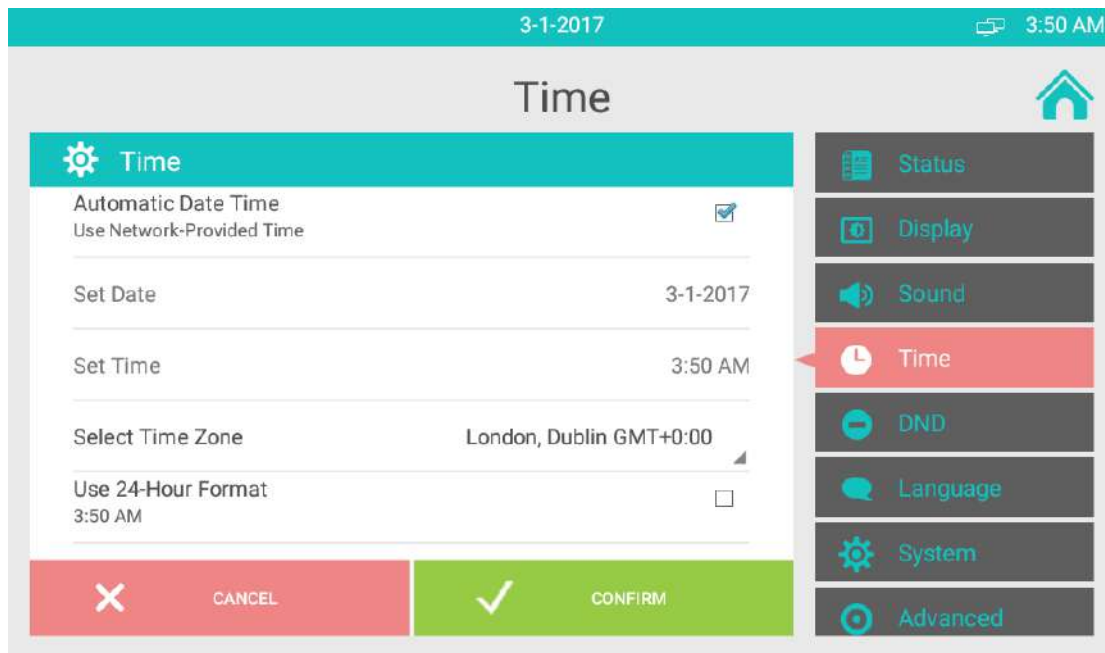

2.7 DND Setting

This function is used to prevent the phone from disturbing. Go to Setting-DND. if open DND, external phone call is unable to call in, turned off by default.

1. Select the desired account
2. Enable/Disable DND function
3. Select valid time of DND. If you don't enable the Time, use All day by default.
4. Choose the return code when DND mode , different mode will send back different message to the server.
5. DND On/Off Code , different server support different On/Off Code. This code is used to enable or disable DND function from SIP server.

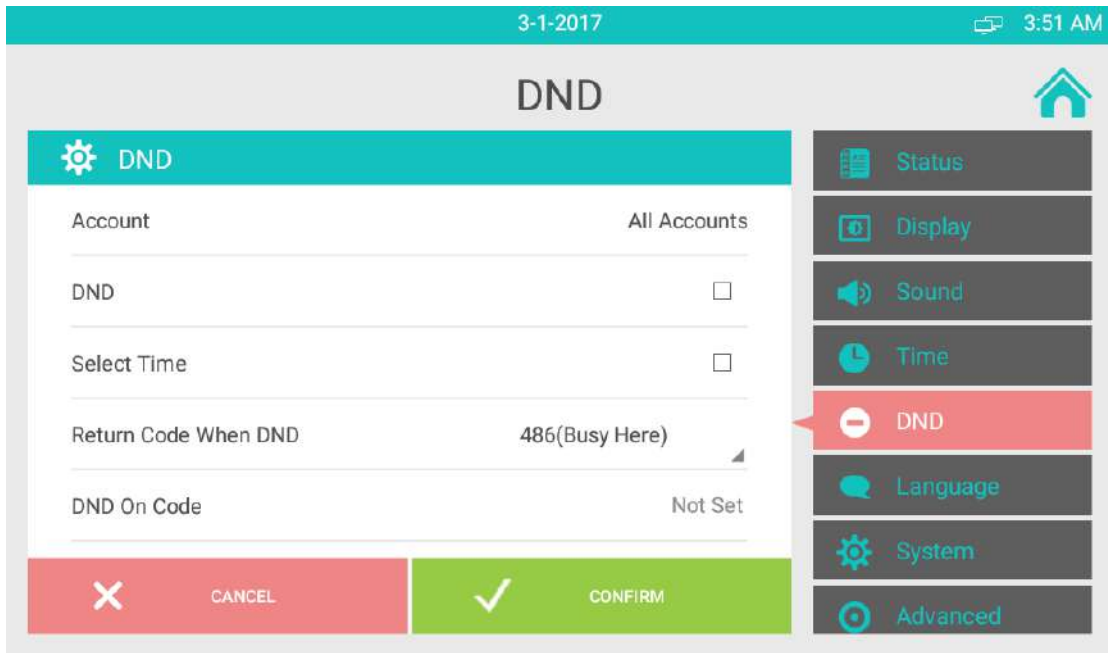

2.8 Language

Choose the suitable phone language. IT&2 use English by default.

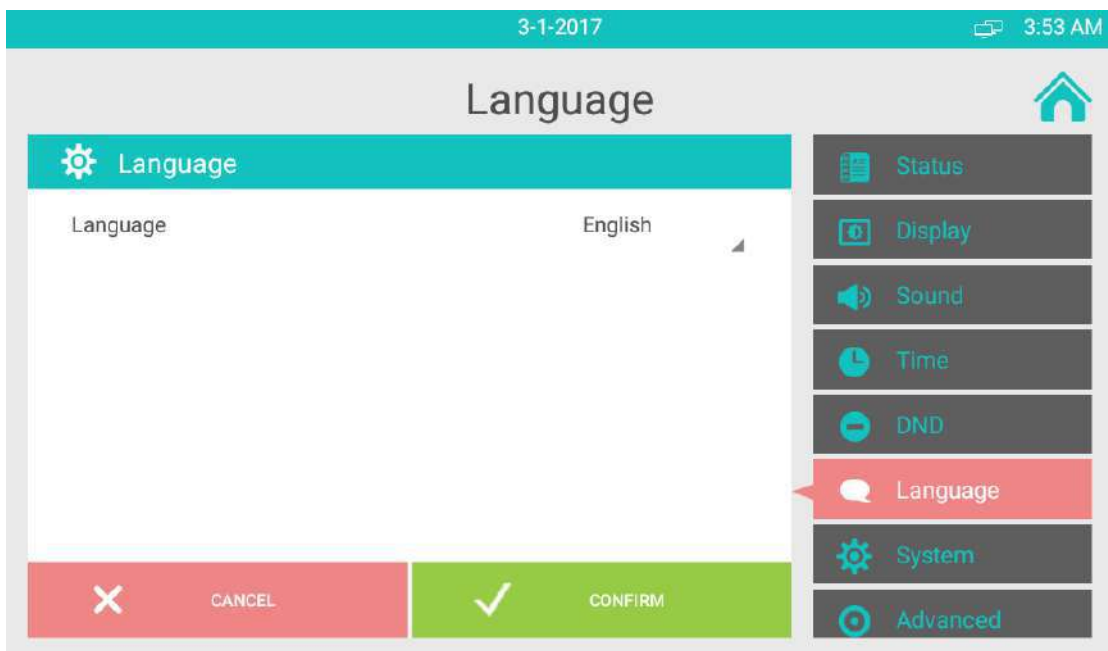

2.9 System

2.9.1 Reboot

To reboot the device ,click OK when you see the prompt. The phone will reboot.

2.9.2 Screen clean

This function is used to protect the device from being pressed any keys when users clean the screen.

2.9.3 Format The SD Card

Click it to format the internal SD Card.

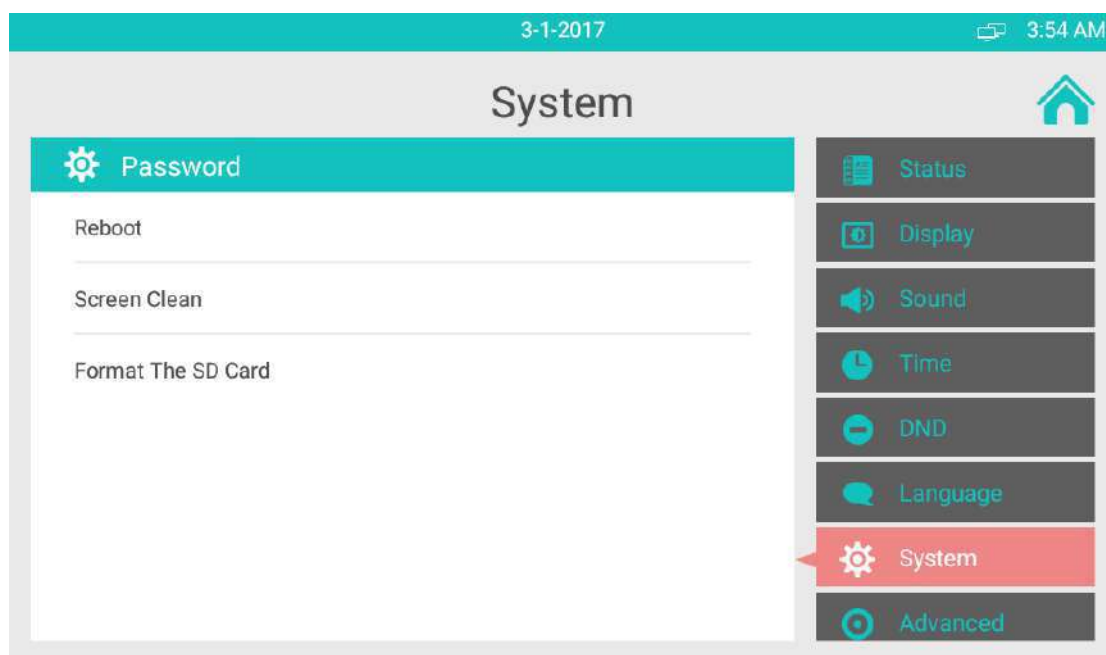

2.10 Backup

Go to Advance-Reset. Choose the Reset mode,click CONFIRM when you see the prompt. The phone will reset to factory setting automatically.

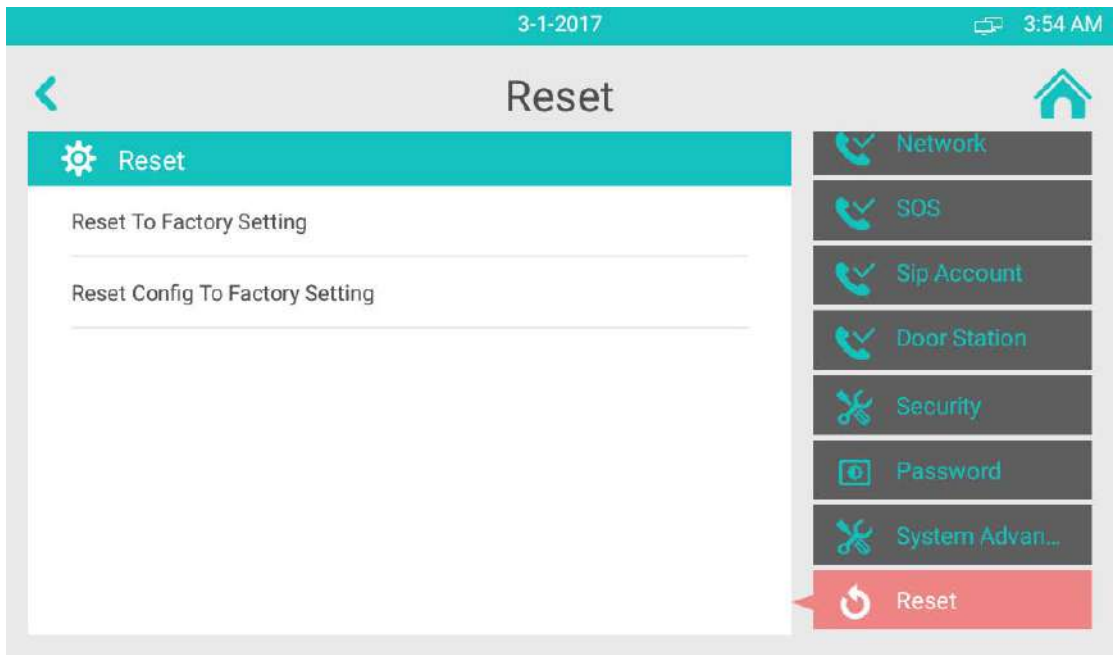

3 Function

3.1 Make a call

User can directly dial from the soft keypad, select from the contact list or from call log to call out the number.

User can choose one of the following steps to enter the dialing interface.

Mode 1: Click Call icon  on the main screen.

Mode 2: Click Intercom button .

3.1.1 Call SIP

If you want to call sip number, you can select Call SIP label. Click the sip number to make a call. The more information about sip account please consult administrator.

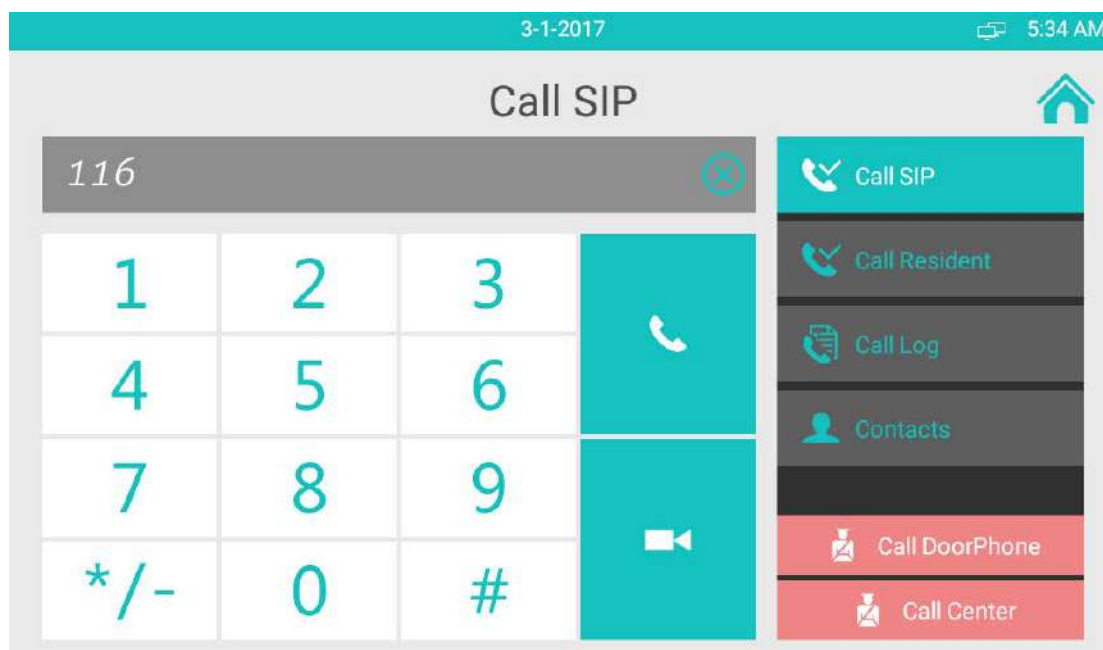

3.1.2 Call resident

If you want to call room number, you can select Call Resident label. For example, if you want to call community 1, Building 1, Unit 1, Floor 1, Room1, you can input digits “001001010101”. Shown as below.





3.1.3 Call from Call Log

User can enter the call log page to make a call.

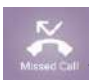
1. In the dialing interface->click Call Log label-> select All Calls/Missed Calls .

2. Click Missed Call icon  to enter call log interface.

If you want to make an audio call, click Audio Call icon . If you want to make a video call, click Video Call .

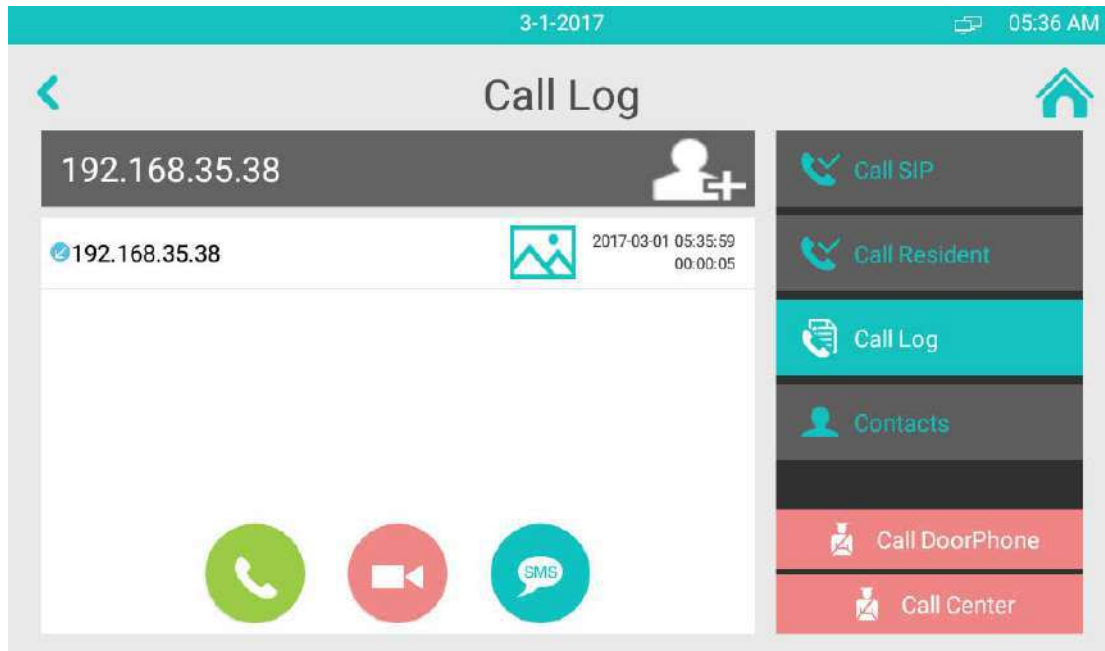



3.1.4 Call from Contacts

User can enter phonebook interface to make a call.

Mode 1: Directly click Contact icon .

Mode 2: Click Call icon  -> click PhoneBook label.

If you want to make an audio call, click Audio Call icon . If you want to make a video call, click Video Call .

Contact is shown as below:

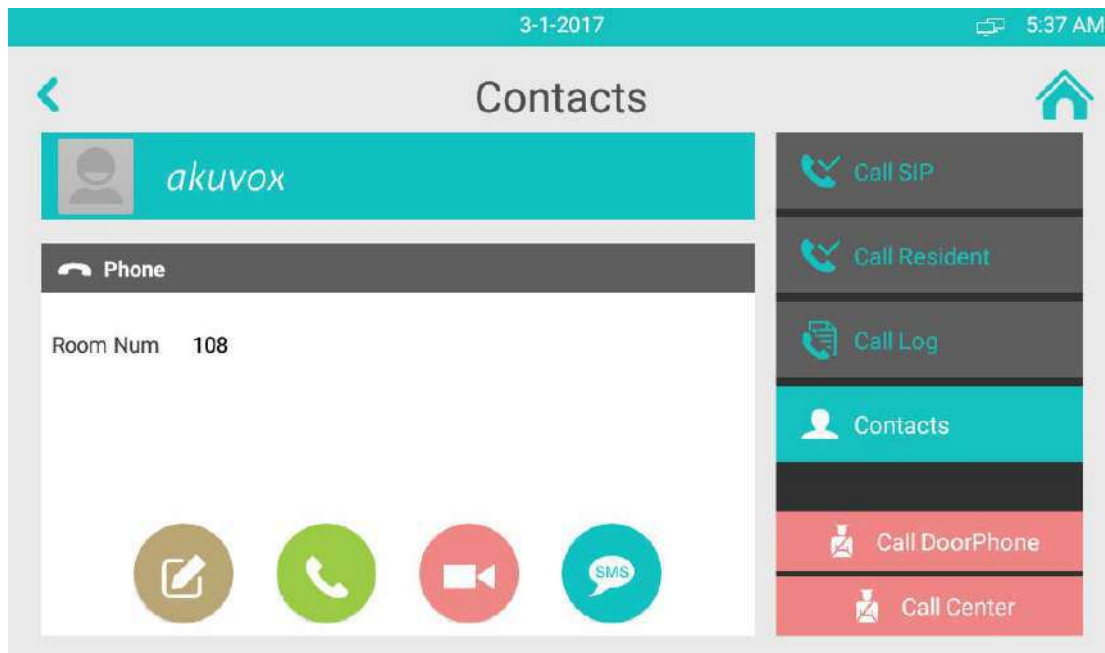

3.1.5 Call DoorPhone

If you want to call door phone number, click Call DoorPhone label

 Call DoorPhone to call out.

- Go to the path: Setting-> Advance(default password: 123456)->Door Station-> click Door Station Number to enter the door number.
- After setup the door phone number, users can call out the Door Phone directly. Click Cancel -o end the call.

3.1.6 Call Center

If you want to call management center (SDMC system), you can press  Call Center to make a call out. This function only can be used when IT82 has registered from SDMC

3.2 Receive a call

Incoming calls include audio and video calls. If the caller has been stored in the contacts, it will show the contact name, otherwise the caller number will be displayed. When IT82 received the video call, it can automatically get a screenshot and save it in the Album.



3.3 Answer a call

1) Answer a audio call

Click Answer to answer the call, press "+/-" to adjust the ringtone volume. As shown below:

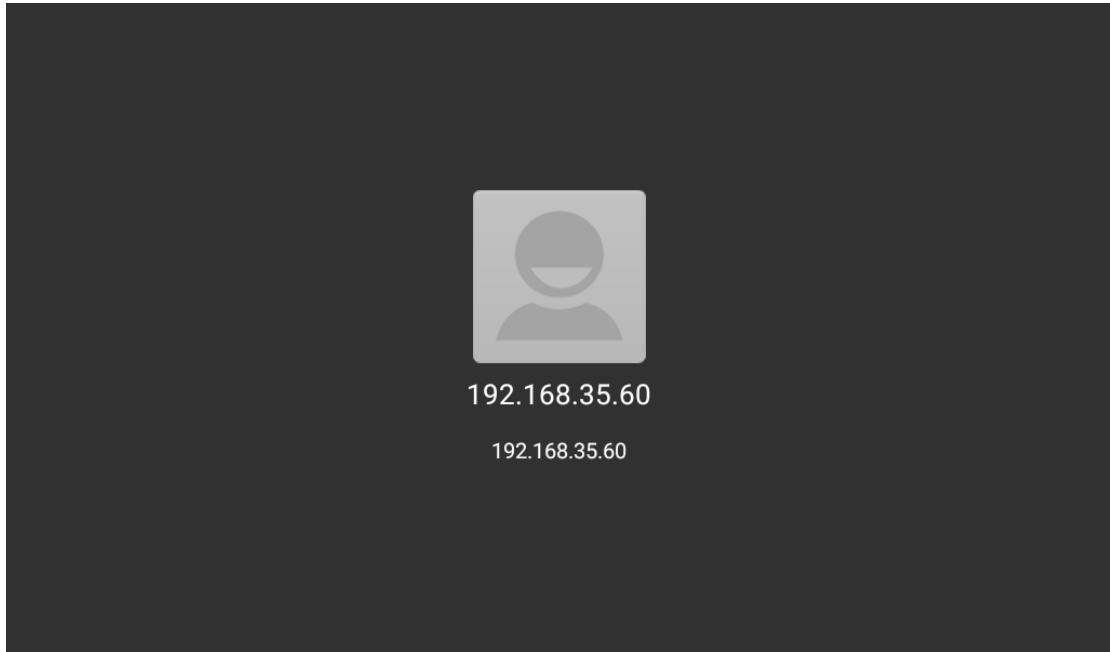

2) Answer a video call

When receiving an video call, the phone will automatically open the video preview so that resident can view the visitors identity. Press Answer o answer the call. As shown below:

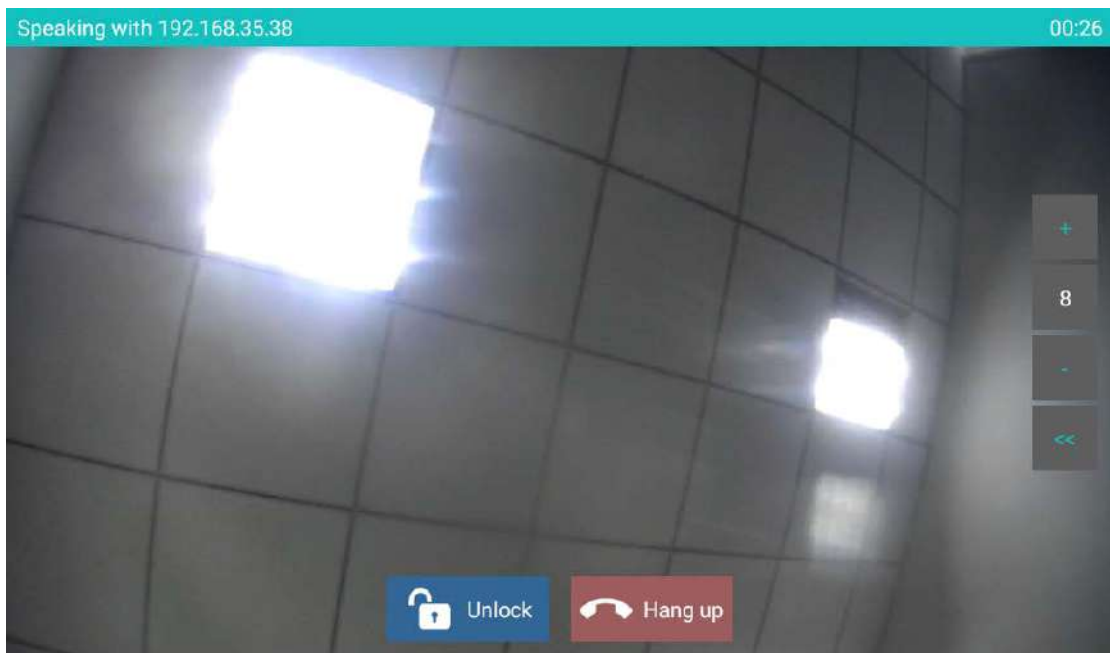

3.4 Reject a call

If user want to reject a call, click Reject label  in incoming interface.

3.5 Contacts

3.5.1 New contacts

1. Click Add button
2. Enter the name
3. Select the number type, and enter the parameters in the corresponding area.
4. Click CONFIRM to save.

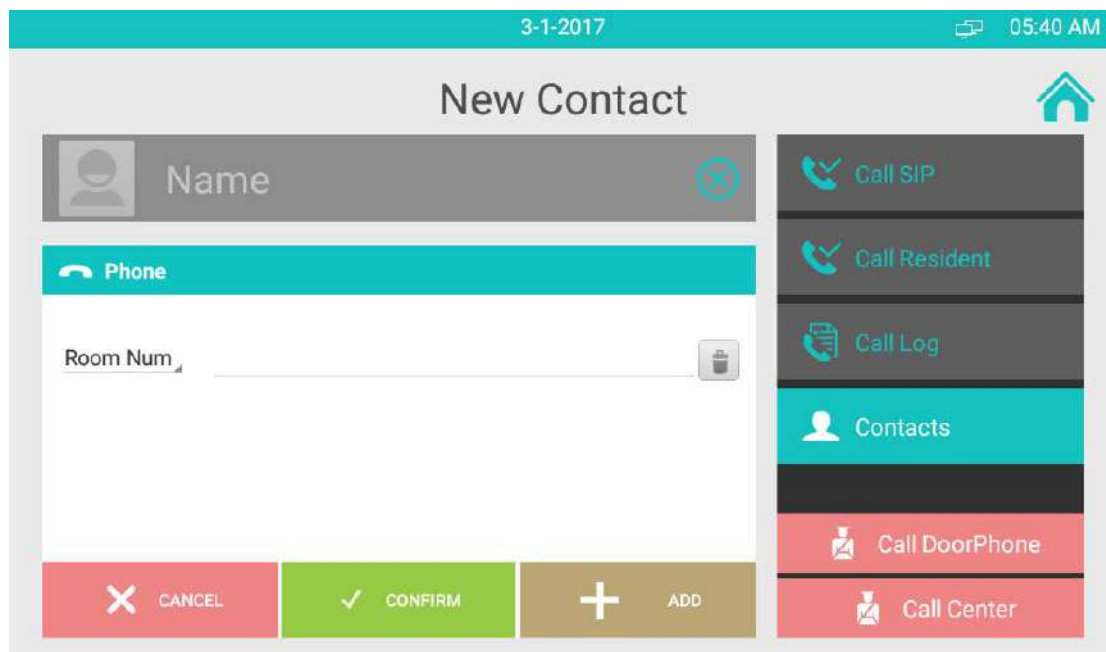

3.5.2 Modify the contact

1. Hold the exited contacts, it will show up a prompt box.
2. Choose Edit
3. Then modify the contact you need.
4. Click CONFIRM to save.

3.5.3 Delete the contact

1. Hold the exited contacts, it will show up a prompt box
2. If you choose Delete and Confirm, you will delete the current contact.
3. If you choose Delete All, all exited contacts will be removed.

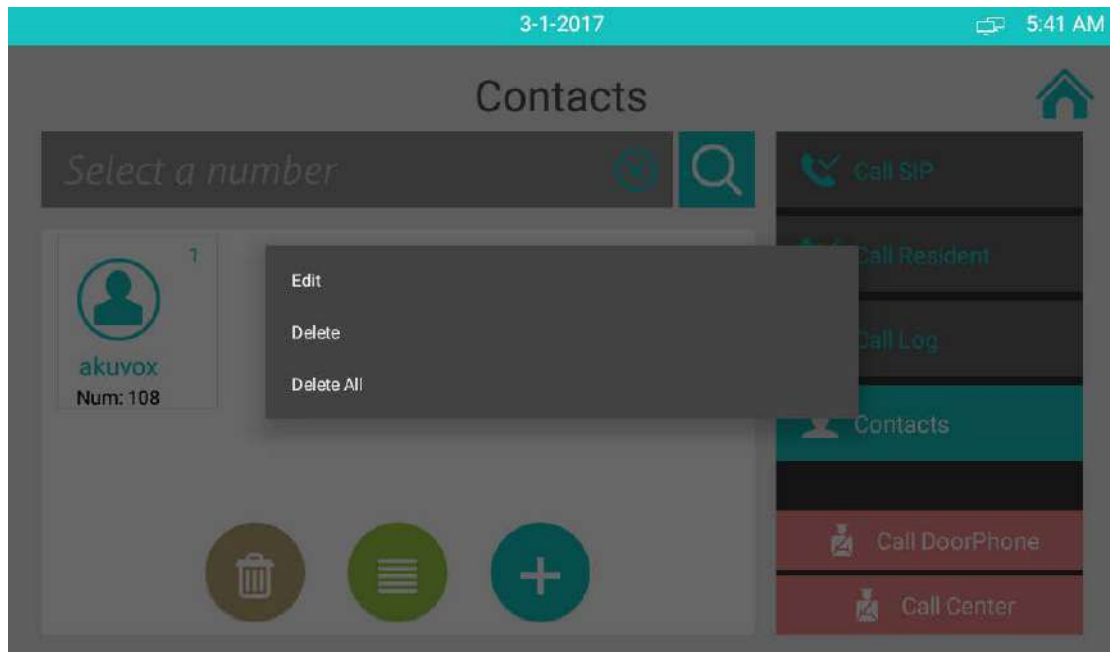

3.6 Call log

Missed call: click Missed call icon, to check all missed call

All Call: to check all missed call, dialed call.

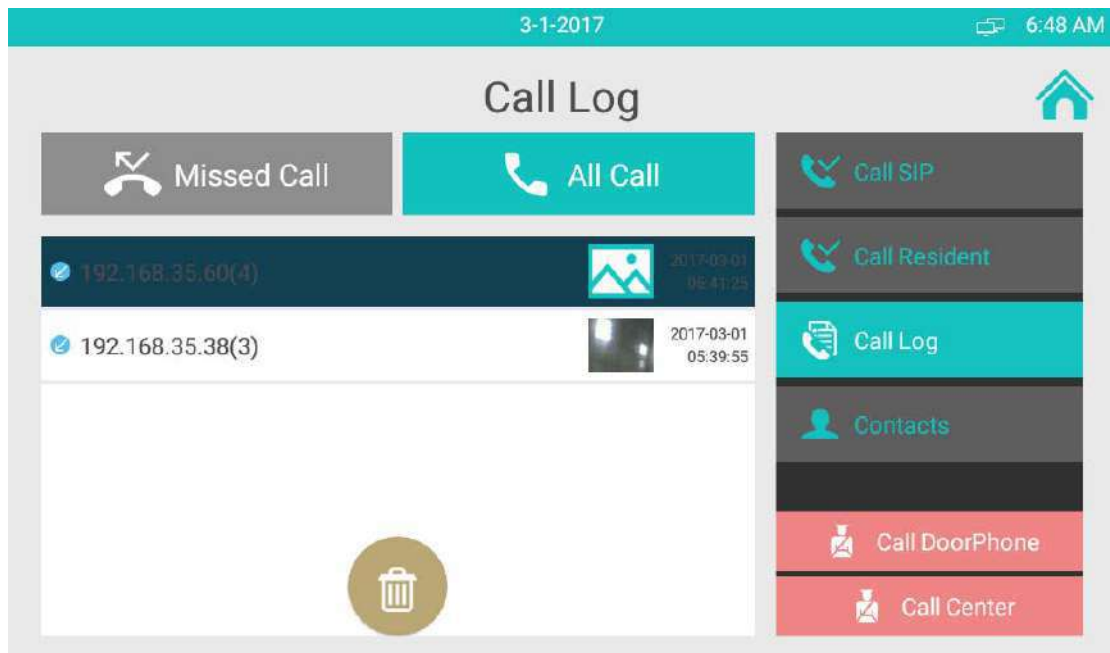

3.6.1 Modify the call log

1. Click the call log, users can make the new contact from the log or add the call log into the existed contact.
2. Click the call log, and press SMS button, edit the message and send out.
3. Or click video or audio call to call out from contact.

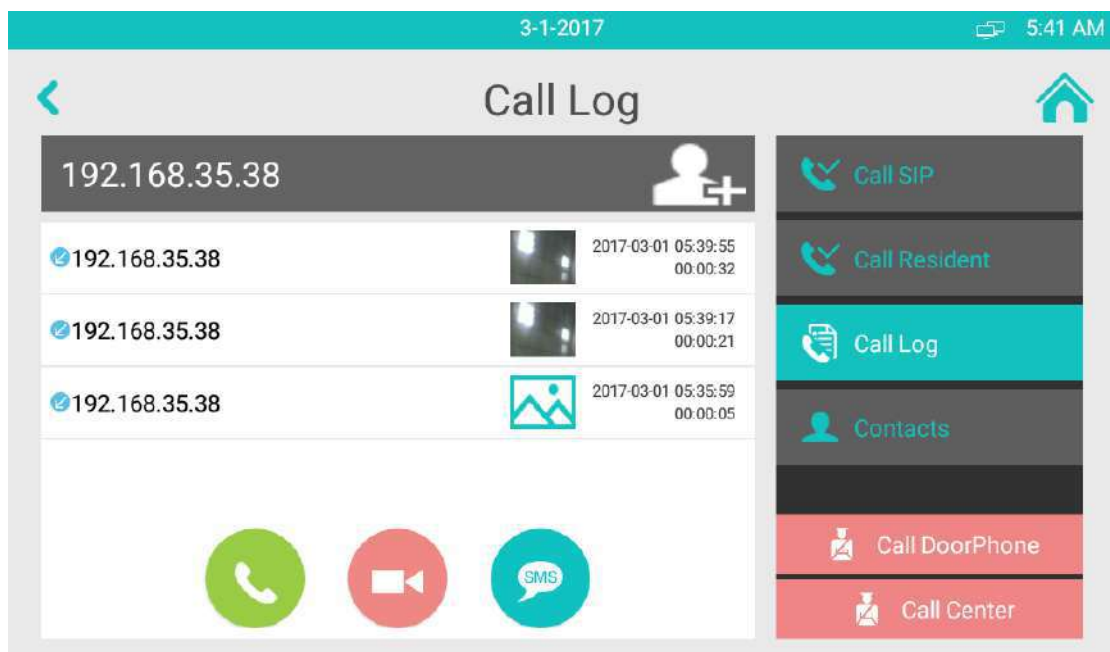

3.6.2 Delete the log

Press delete button , then choose which log you want to delete. Click CONFIRM to remove it.

3.7 Capture

IT82 supports capture the visitor photo when incoming preview. IT82 can auto capture if the phone can not be answered after 3 seconds. Or user can capture manually via press capture icon 

3.8 DND

Click DND icon  to enable or disable DND function. The concrete configuration of DND ,please refer to chapter

3.9 Auto Answer

Enable Auto Answer function, IT82 will answer the incoming call automatically.

1. Go to the path: Setting-Advanced-Sip Account
2. Tick Auto Answer
3. Click CONFIRM

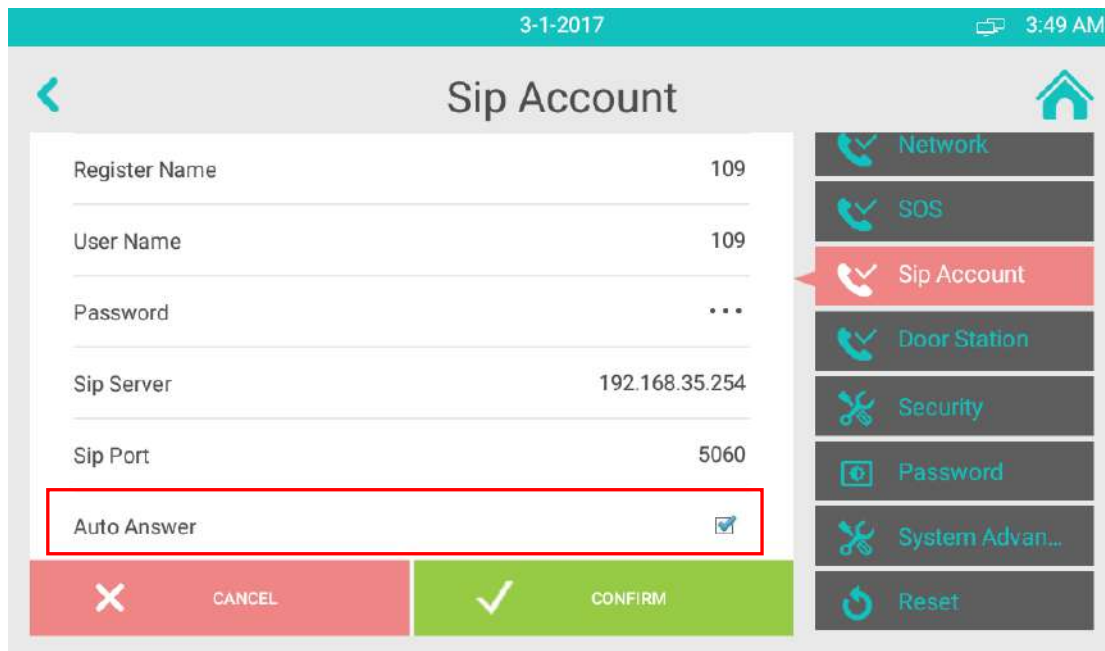

3.10 Message

Note:This function only can be used when IT82 registered from SDMC(Management center)

3.10.1 Alarm

When the alarm is triggered , users can check the alarm message in this area.

3.10.2 Message

Users can receive and send the message in the message interface

3.10.3 Maintenance

Any parts of your house is broken, users can select the corresponding item, then to send the message to the management center. More information of SDMC ,please consult your administrator.

3.11 Live View

Live view is used to monitor the door phone via using RTSP.

1. Click Add
2. Enter the door phone RTSP address. (please make sure the address format is right)
3. Click CONFIRM to save.

Then users can check the live video from the door phone any time.

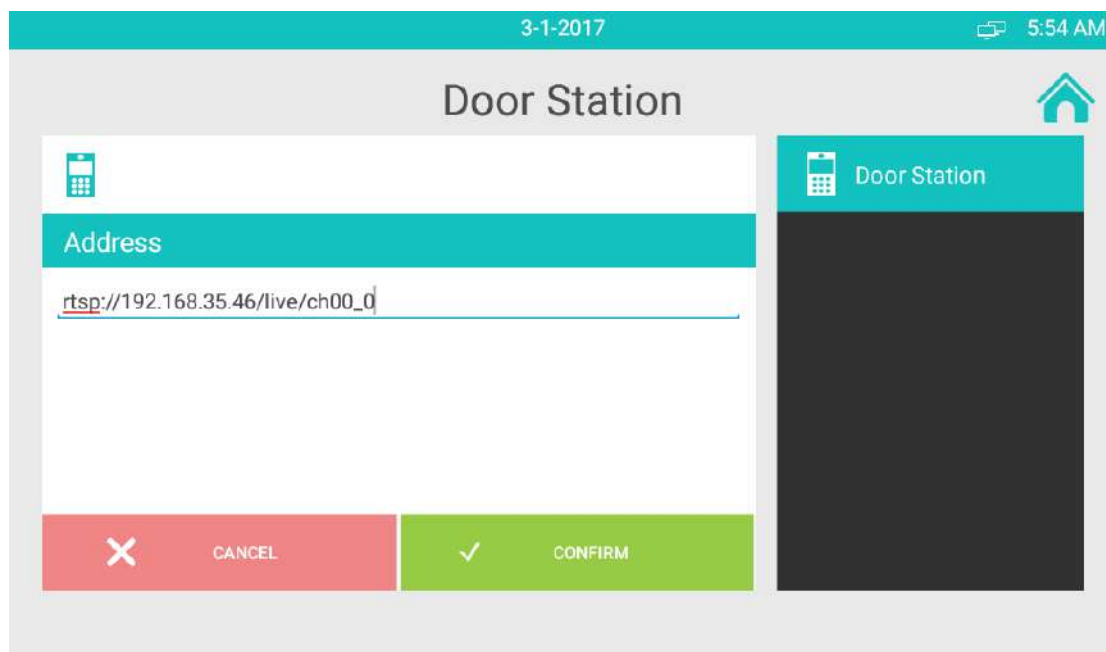

3.12 Unlock

IT82 supports remote unlock the door phone via using DTMF code. During the call,

users can press Open Lobby label  to open the door during the call.

Note: IT82 default DTMF code is #. Users need to predefine the same DTMF code of door phone and IT82. Configuration DTMF code, please consult your administrator.

3.13 SOS

SOS key is used to call out the emergency number in case of emergency. IT82 will

call out for three predefined numbers in a loop, each number will be called for 60s (by default).

1. Go to Setting-Advanced-SOS
2. Set up 3 emergency number.
3. Setup the call Timeout
4. Set up the loop time
5. Click CONFIRM to save



3.14 Security

IT82 support connect 10 alarm area via using RS485 contacts. Up to 5 Alarm Type - Infrared, Drmagnet, Smoke, Gas and Urgency and two trigger mode - NC(normal close) and NO(normal open) . Setup alarm delay, the alarm will ringing after the alarm has been triggered. Open or close Alarm Status to enable or disable this function.

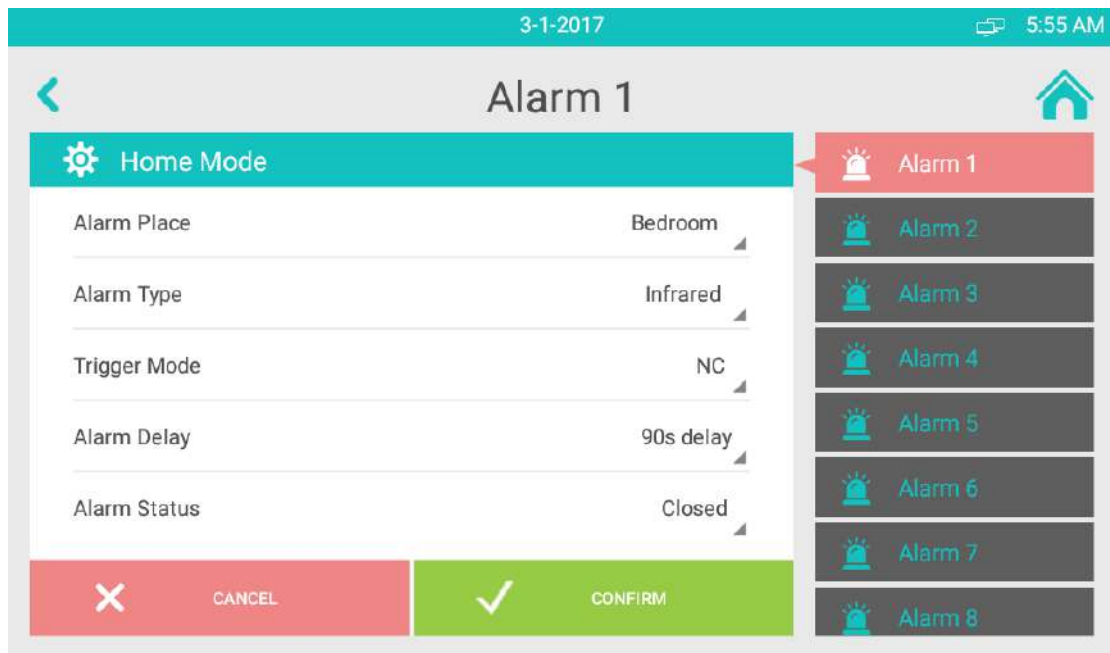

When the alarm is triggered, click Cancel and input "0000" to disable it.

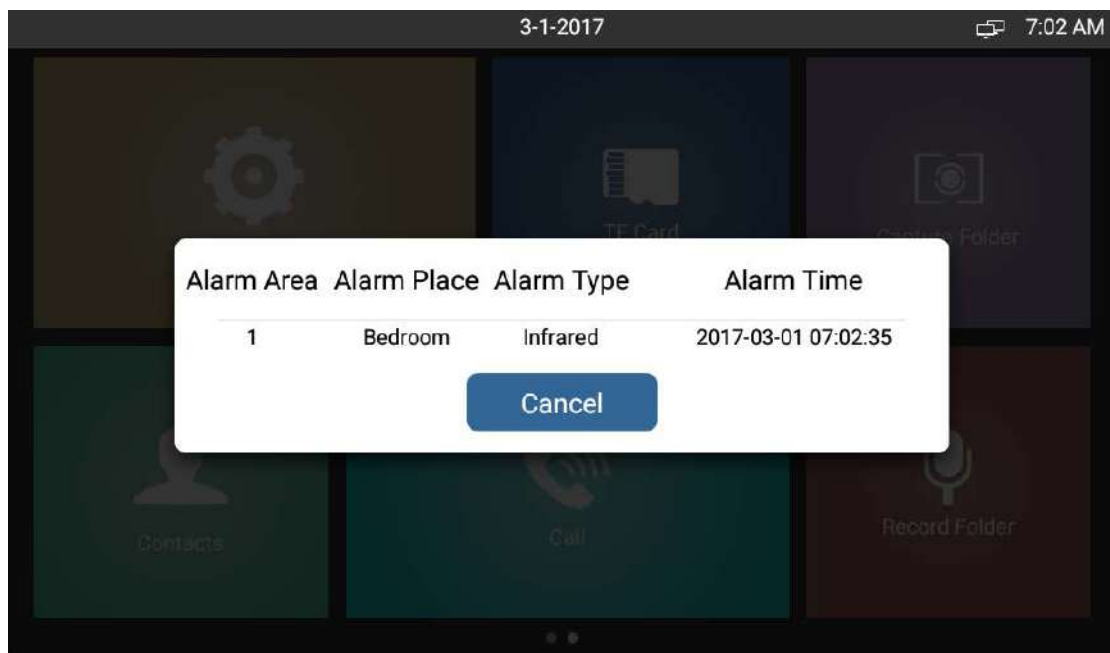

3.15 System Advanced

3.15.1 SSH console

This function is used to connect SSH to debug the device configuration. Only tick this

function, the device can be connected.

3.15.2 Upgrade

Use the SD card to upgrade the firmware. Please refer to chapter 3.16.

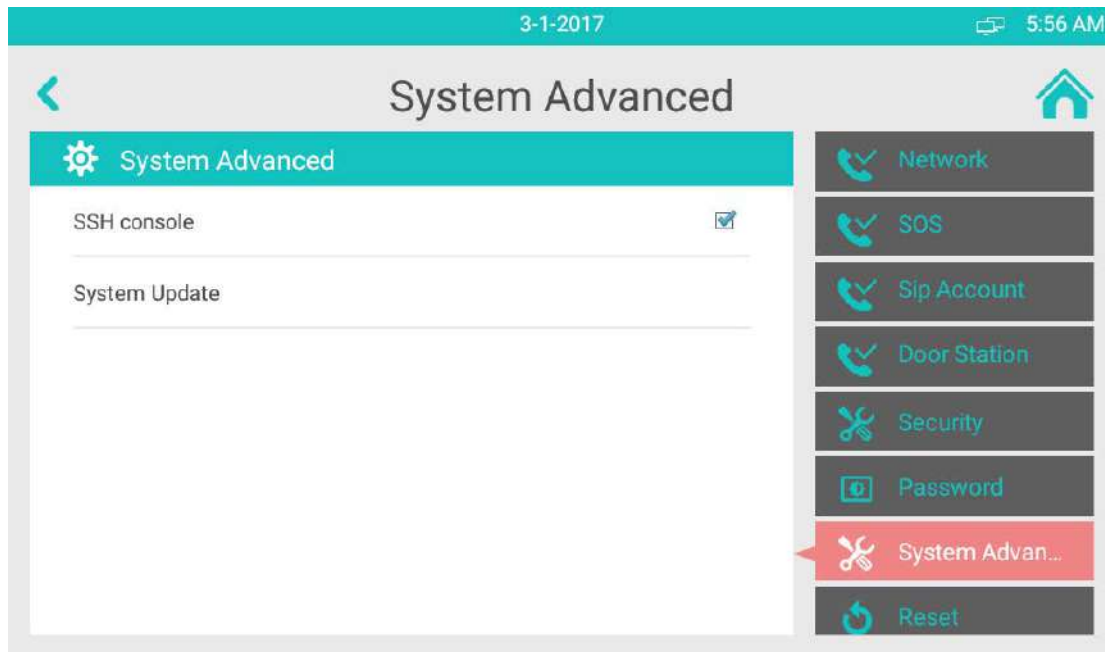

3.16 Upgrade

IT82 supports two types to update the new firmware.

1. Upgrade by SD card

Copy the firmware to SD card. Insert the card into IT82. Go to the path: Setting-System Advanced-System update . Click SELECT OTHER UPGRADE PACKAGE, then find the firmware in SD card, click OK then begin to upgrade.

2. Upgrade by website

Login in the website, go to the path: Upgrade-Basic. Select the firmware then click Submit.

Upgrade-Basic

Firmware Version

82.0.2.20

Hardware Version

1.0

Upgrade

未选择任何文件

